

Customer : Wüsten Elektronik

Drawing No. : 1032356-53150

Seite 1 / 1

created: hs 02/06/2018 08:44:00

Typ : SZ16055025040

RoHS Compliant

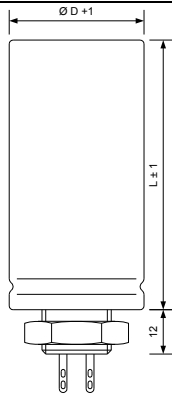

∅ D : 25 mm

L : 40 mm

mounting : M18 x 1,5

Terminals : solder lugs

Pin Configuration

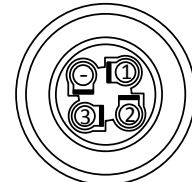

-	Ground	2	Cap 2
1	Cap 1	3	Cap 3

Electrical Parameters

Rated Capacitance (C_R) @ 100 Hz / 20 °C	16 + 16 μ F	Cap 3: n.c.
Tolerance	-10 +30 %	
Rated Voltage (U_R)	550 V	
Surge Voltage (U_S) max. 5 x 1 min / h	600 V	
Reverse Voltage (U_U) max. 1 s	2 V	
Leakage Current (I_L) @ U_R / 5 min / 20 °C	42 μ A	
ESR typ. @ 100 Hz / 20°C	6000 m Ω	
Tan δ typ. @ 100 Hz / 20°C	6 %	
Z max. @ 10 kHz / 20°C	4800 m Ω	
ESL typ.	60 nH	
Rated Ripple Current (I_R) @ 100 Hz / 85 °C	0,2 A	
Useful life @ I_R , U_R , 85 °C	2500 h	
IEC Climatic category / Standards	40/085/56	IEC 60384-4
Applications	valve amplifier, replacement	
Your article No. / Project		